



NA1850 AV Media Receiver User Manual



Enjoy the Lifestyle of In-Car Entertainment



CONTENTS

Contents

Thank you for purchasing a Nakamichi products.

Please read all instructions carefully before operation, to ensure your complete understanding and to obtain the best possible performance from the unit.

INTRODUCTIONS

View demo before first use.....	2
Overview the unit.....	3
Basic operations.....	4

AV MEDIA

Listening to the radio.....	5
Playing the music.....	6
Enjoying the movie.....	7
Viewing the photo.....	8
Sharing your iPod/iPhone.....	9

BLUETOOTH

Using bluetooth.....	10
----------------------	----

AUDIO ADJUSTMENT

Equalizer.....	11
Subwoofer.....	12
Speaker.....	13
Audio zone.....	13
Time alignment.....	13
Fader/Balance.....	13
5.1 Audio playback.....	14

NAVIGATION

Navigation settings.....	15
--------------------------	----

REFERENCE

Specifications.....	16
---------------------	----

INTRODUCTIONS

View demo before first use

Please preview those advance features of this unit through the DEMO mode on this unit.

1. Access to general settings.



2. Turn on the demo mode.



3. Press & hold this button to power off the unit, demo will be play automatically.



4. Tap to stop

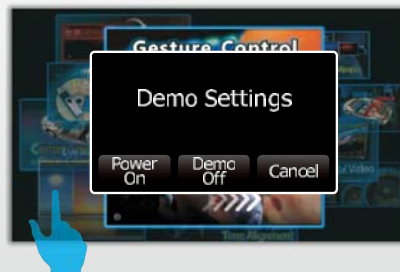

INTRODUCTIONS

Overview the unit

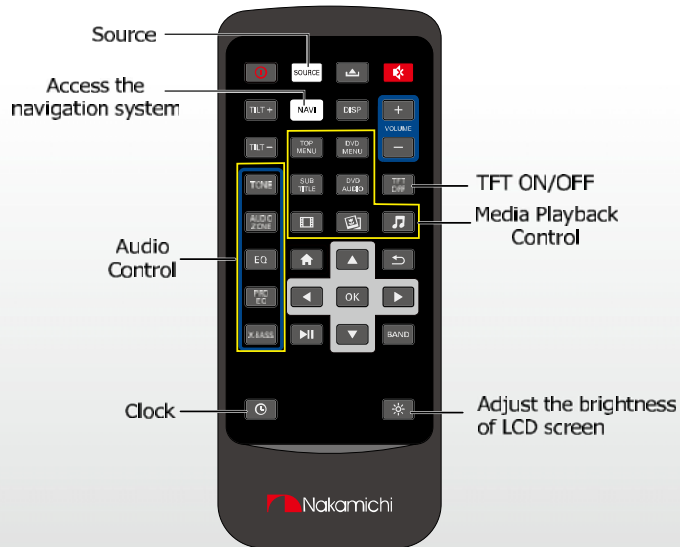

INTRODUCTIONS

Basic operations

Access to HOME



Access to CLOCK / WIDGETS



Pop up the AUDIO CONTROL

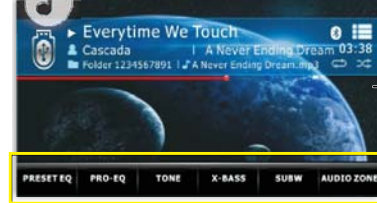

Direct to PLAYBACK TIME



Swipe for DRAG TO



Swipe left/right for UP/DOWN



Rotate for VOLUME adjust



Tap center to MUTE





AV MEDIA

Listening to the radio

Swipe left/right AUTO SEEK



Tap MANUAL SEEK



Tap BAND to change to FM or AM



PRESET LIST/
TUNER FUNCTION



AV MEDIA

Playing the music

Swipe drag to
PLAYBACK TIME

Tap direct go to
PLAYBACK TIME

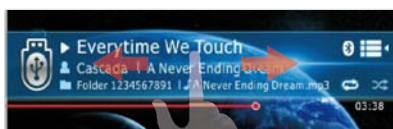

Swipe UP/DOWN

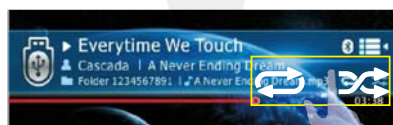

Tap REPEAT / RANDOM

Tap PLAY / PAUSE



QUICK BROWSER

Operation steps:



1. Connect the desire playback device(USB/SD/iPod) to the USB or SD socket.
2. Access to HOME, then tap the desire playback device(USB/SD/iPod).
3. Playback starts.

AV MEDIA

Enjoying the movie



1/2 2/2	Change function bar
5.1CH 4.1CH	5.1CH & 4.1CH selection
	Select the audio type. (For DVD-VR:Select the audio channel)
	Subtitle type.
	Top Menu or Browser
	Previous, Pause /Play, Next
	Audio Settings
4:3 16:9	Select aspect ratio
	Brightness
	Contrast
	Saturation
	Repeat playback mode
	Zoom the video & photo
PBC	PBC on/off (VCD only)



AV MEDIA

Viewing the photo

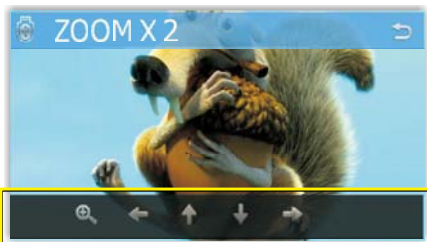
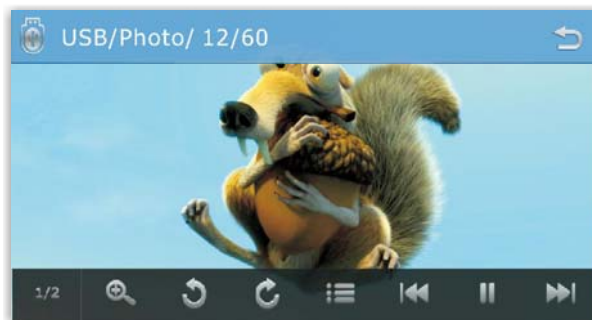

When zoom x2,x4,x8 will pop up the arrow button to move the photo.



Rotate function only can support for original size photo.

	Rotate left
	Rotate right
	Move left the zooming frame
	Move up the zooming frame
	Move down the zooming frame
	Move right the zooming frame



AV MEDIA

Sharing your iPod / iPhone

iPod/iPhone music playback

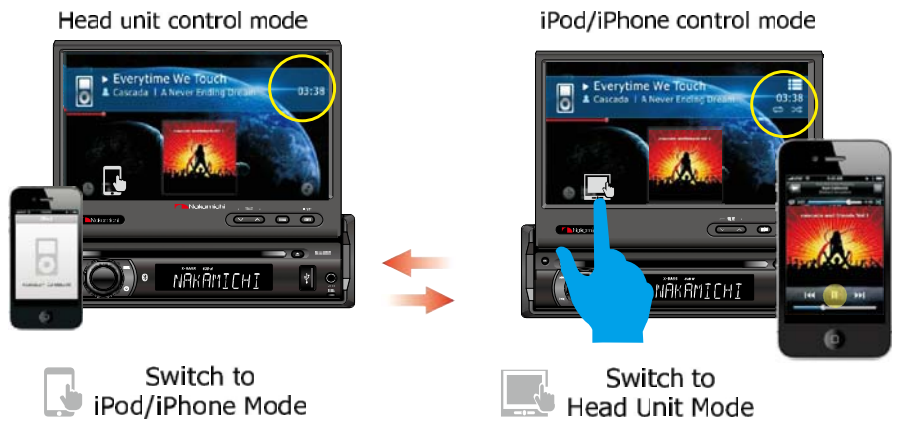

iPod touch / iPhone video playback

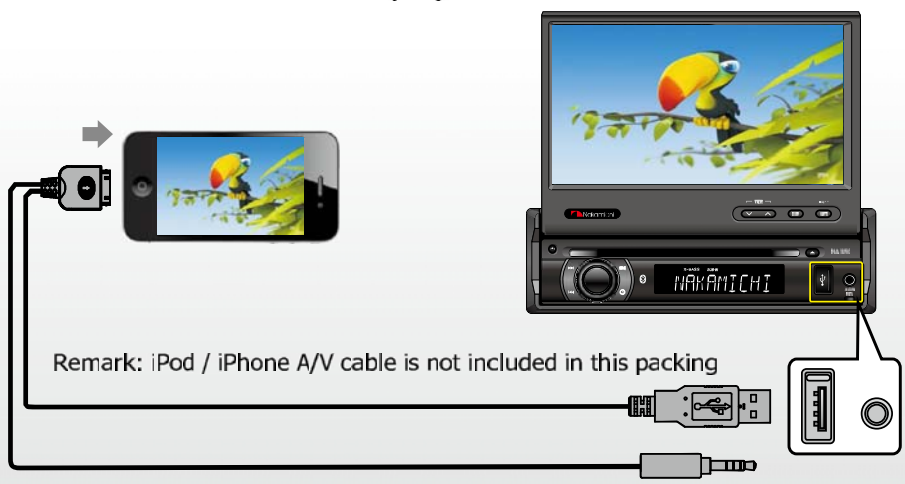

BLUETOOTH

Using bluetooth

How to pair & connect device ?



How to disconnect ?

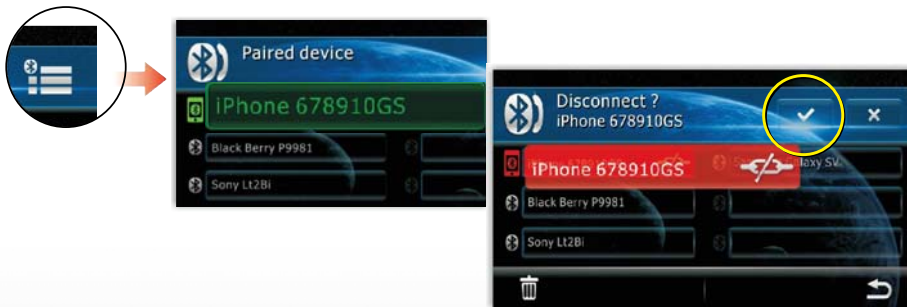

How to delete ?

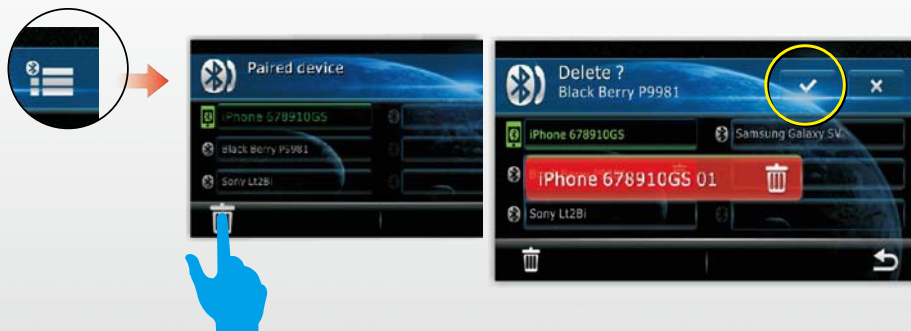



AUDIO ADJUSTMENT

Equalizer

10 Preset EQUALIZER



Preset EQ(USER)



TIPS Access to user preset EQ mode

Resume to factory default value

11 Band professional EQ



3 Band Tone control



X-BASS Enhance



AUDIO ADJUSTMENT

Sub-woofer

SUB-WOOFER settings



Low Pass Filter Transfer Function

- 80 Hz
- 120 Hz
- 160 Hz

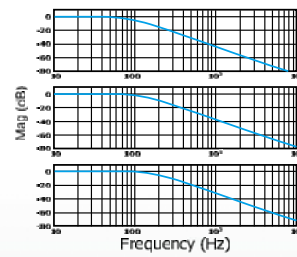

AUDIO ADJUSTMENT

Speaker

Audio Zone

7 preset listening zone to fit with perfect listening position



Custom Made Time Alignment

Precisely adjust each speaker including, Sub-Woofers speaker output timing according to its distance from the listening position

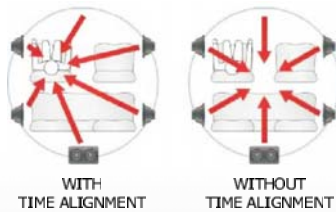

Adjust fader & balance to get the perfect sound.



Adjust the High Pass Filter range: 80 / 120 / 160Hz



AUDIO ADJUSTMENT

5.1 Audio playback

How to activate 5.1 audio mode



How to adjust 4.1 audio speaker setting

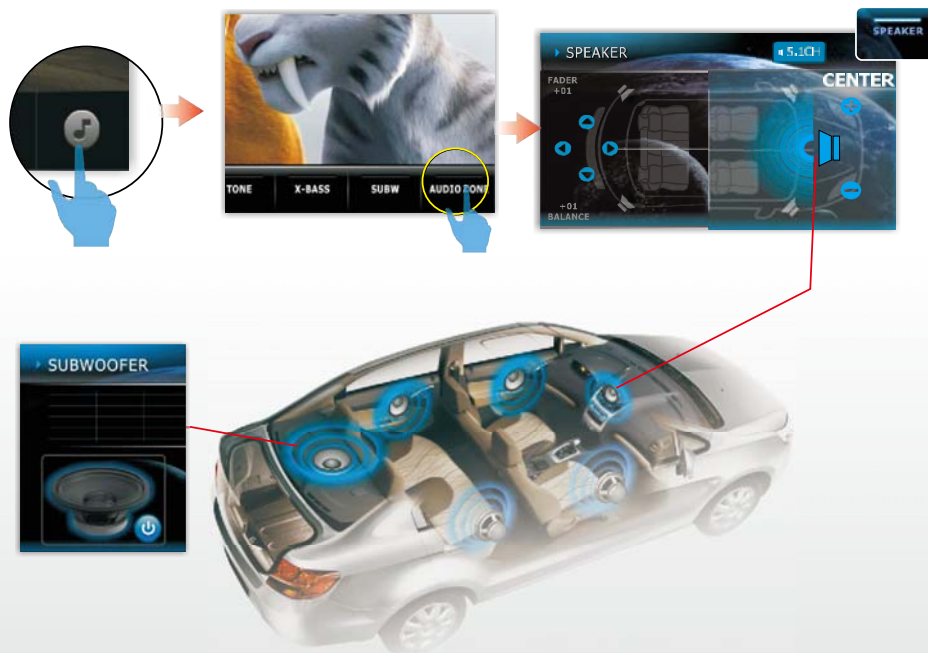

- TIPS**
1. Please read details of recommended 5.1 audio speaker connection in the manual of installation / connection (QSG).
 2. XBASS & ZONE function is not available when 5.1 audio playback mode is switch on.



NAVIGATION

Navigation settings

Set the navigation program path



Navigation Voice Output

Select the voice output from the desire speaker location



Navigation Voice scale Level

Adjust the voice level scale between playback sound



REFERENCE

Specifications

TFT Monitor section

Screen Size	:7 inches
Display Resolution	:800x480 dots
Contrast Ratio	:500

Disc player section

Disc System	:DVD/CD/VCD
Disc Diameter	:12cm
Frequency Response	:20Hz - 20kHz
Signal/Noise Ratio	:>75 dB
Total Harmonic Distortion	:Less than 0.3%
Channel Separation	:>50 dB
Video Signal Format	:NTSC/PAL
Video Output	:1+/-0.2V p-p

USB interface section

USB Standard	:USB 2.0 Full Speed
File System	:FAT 16/32
Maximum Current	:DC 5V= 1A
D/A Converter	:24Bit
Video Decoder	:MPEG1/MPEG2
Audio Decoder	:MP3

Memory Card section

Memory Cards	:SD/SDHC
Maximum Capacity	:32G

Bluetooth section

Communication System	: Bluetooth Standard version 2.0
Output	: Bluetooth Standard Power Class 2
Maximum Communication Range	: Approx. 5meters
Frequency Band	: 2.4 GHz
Compatible Bluetooth Profiles	: HFP/HSP/A2DP/AVRCP
Supported Codecs	: SBC (Sub Band Codec)

Radio section

Frequency FM range	: 87.5 - 108.0 MHz
Frequency AM(MW) range	: 522-1620 KHz
Usable sensitivity	: 2 uV (FM) : 80 uV (AM)(MW)

Video section

Color System of External Video Input	: NTSC/PAL/SCEAM
External Video Input (RCA/3.5m Jack)	: 1 Vp-p /75Ω

Audio section

Maximum Power	: 50Wx4
Continuous Power Output (RMS)	: 22 Wx4
Preout Level (V)	: 4 V/10kΩ
Preout Impedance	: ≤ 600Ω
Speaker Impedance	: 4-8 Ω
External Audio Input Level (RCA)	: 1 V/10KΩ
External Audio Input Level (3.5mm Jack)	: 600mv/10KΩ

General

Operating Voltage	: 14.4V(10.5-16 V)
Dimension(WxHxD)	: 188x58x218.7mm
Operational Temperature Range	: -10°C-+60°C
Storage Temperature Range	: -20°C-+80°C
Weight	: 2303g



Design and specifications are subject to change
without notice

© 2013 Nakamichi
www.nakamichicaraudio.com

